

Gallery for presentation and serving



Cooled H3 hygienic muffles

MULTI-FUNCTIONAL TRANSPORT AND SERVING TROLLEY

The new breakfast trolley is a mobile unit made of stainless steel. One of its special features is that it is an alternative to the tray system for serving breakfast and dinner in hospitals and in the care sector. The trolley is also ideally suited for snacks and events. Furthermore, it can be used for general catering, school catering and community catering. The Premium models are fitted with electrical sockets in order to ensure that the food remains perfectly hot until it is being served. You can, for example, plug a K-POT into a socket. In principle, the

breakfast trolley is available in 2 sizes as well as in a refrigerated or neutral version. The trolley can be moved around on plastic rollers and has four corner bumpers and two pushing handles. Due to its individual and modular design, the trolley is ideal for all kinds of use. The drawers and cupboard compartments in GN format offer sufficient storage space for trays and accessories. Hygienic working due to the stainless steel panels.



K-POT® - the mobile kitchen.
Tabletop unit for keeping food hot and cold as well as cooking and serving.



thermoplates® 4.0 made of SWISSPLY® multi-layer material - the cookware in GN format. Clear identification due to the QR code (transparency in the food flow).



MOBILE °CHECK
Measuring, capturing, evaluating and thinking for itself - for optimum food quality.

Breakfast trolleys

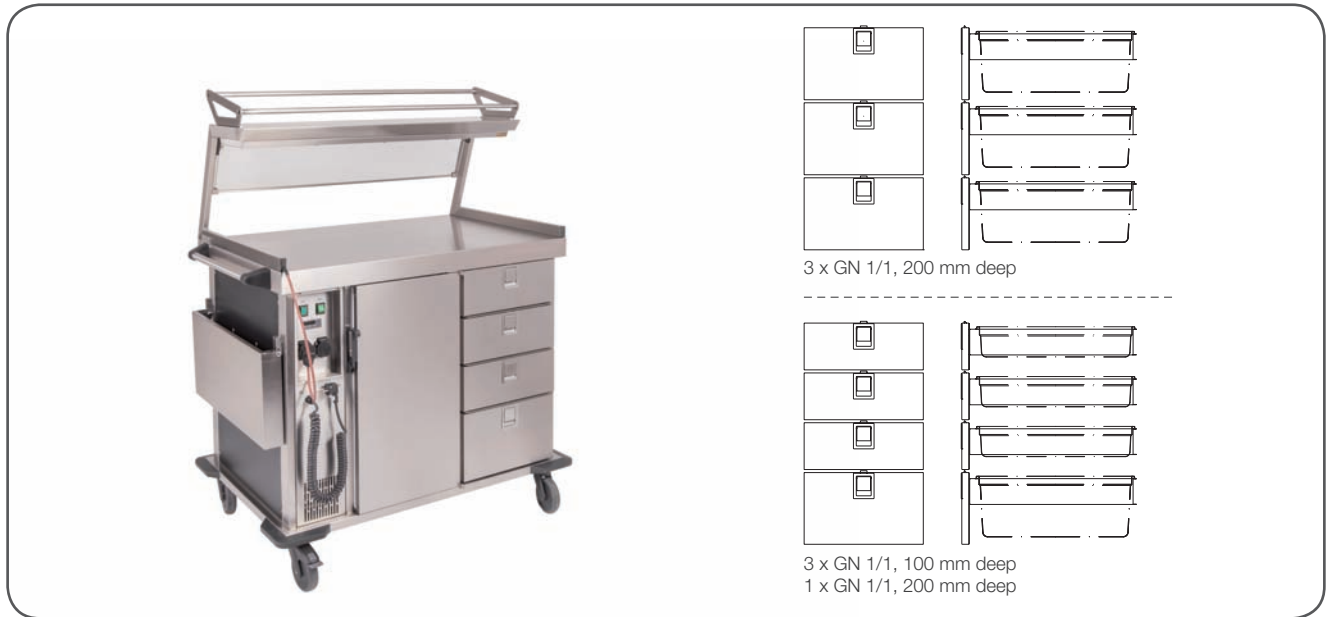

TECHNICAL DATA.

Premium models:

Refrigeration compartment on the left-hand side with thermostat controller and H3 hygienic muffles, refrigeration range from -12 °C to +8 °C. Refrigeration power 180 Watt, R 134a coolant. Fitted with 16 pairs of support rails for a maximum of 7x GN 1/1, 65 mm deep, or 16x GN 1/1, 20 mm deep. Additional cooled worktop and passive refrigeration with cooling pellets are possible. 3 or 4 optional drawers on the right-hand side. 230 V design, connected load of sockets 3.2 kW, total connected load maximum 3.5 kW. Cable length 2.5 m. Weight from 138 kg to 195 kg depending on design and accessories.

Optional extensions: 3-sided Formica panelling in blue, grey, black and light green (further colours available on request). Fold-down shelf 300 x 600 mm, waste bin (21 litres) for hanging into the unit, light attachment with germ guard, 3-sided gallery, tray slide, serving attachment for GN containers, acrylic doors, drawers, stainless steel panels, H3 hygienic muffles, cooled cover for 2x GN 1/1.

VERSIONS

Standard models

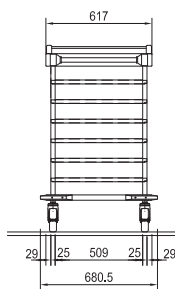

Order no.: 88 04 21 20

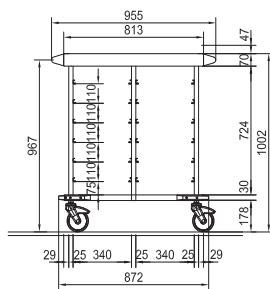

Order no.: 88 04 21 22

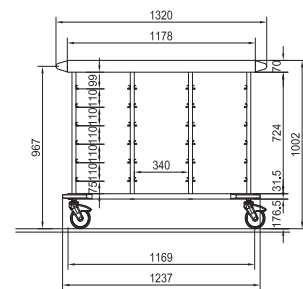
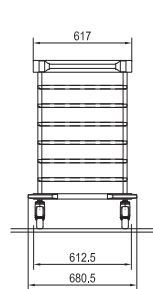

Premium models

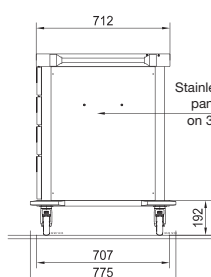

Order no.: 88 04 21 21

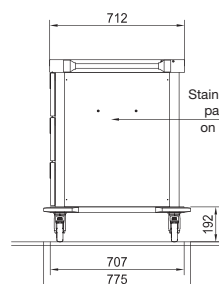
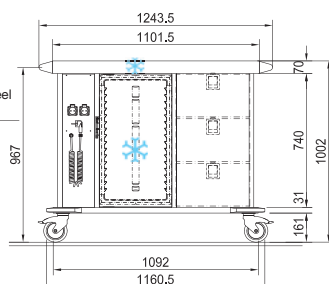

Order no.: 88 04 21 23

